

DevClub FHI

Bas Verhelst

20 november 2014

Agenda

- § 13.00 – 13.30 Ontvangst
- § 13.30 – 14.00 Development Club
- § 14.00 – 14.30 Introductie Bosch Rexroth
- § 14.30 – 14.45 Pauze
- § 14.45 – 15.15 Lezing: Visie op Industrie 4.0
- § 15.15 – 16.00 Case: System on Chip oplossing voor toekomstige producten ?
- § 16.00 – 16.30 Rondleiding Bosch Rexroth
- § 16.30 – 17.30 Afsluitende borrel







We are the Drive & Control Company

Welcome to Bosch Rexroth



Part of Bosch Group*

Bosch Group	<ul style="list-style-type: none">è 46,1 billion euros in salesè 281,000 associates		
Automotive Technology	<ul style="list-style-type: none">è One of the world's largest suppliers of automotive technology	66 % share of sales	
Industrial Technology	<ul style="list-style-type: none">è Leading in drive and control technology, packaging, and process technology	34 % share of sales	
Energy and Building Technology	<ul style="list-style-type: none">è Leading manufacturer of security technology and global market leader for residential heating systems		
Consumer Goods	<ul style="list-style-type: none">è Leading supplier of power tools and accessoriesè Leading supplier of household appliances		

*NB – Slide 23: Bosch no longer includes fifty-fifty joint ventures in its accounting (mainly concerns BSH Bosch und Siemens Hausgeräte GmbH and ZF Lenksysteme GmbH). Current figures for sales, result, and headcount are comparable with 2012 figures to a limited extent only.

From large to small



Every machine

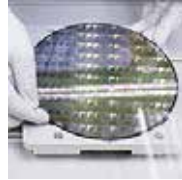

Each project



Many applications, multiple industries



From massive to miniature



Providing life time service

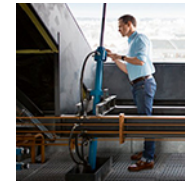

With global strength to local markets



With leading edge technology



Founded on a strong team

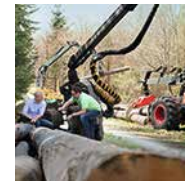

We move everything

Every industry has specific needs

Mobile Applications



Machinery Applications and Engineering



Factory Automation

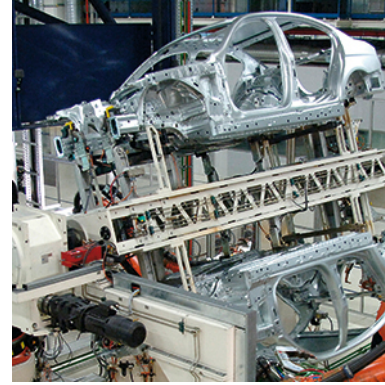

Renewable Energies



- § Reflect specific needs and requirements of markets and industries
- § Bundle relevant technologies, application expertise and services
- § Global presence combined with local know-how
- § Proximity to customer

We have deep industry knowledge

Semiconductor and solar – overview

Semiconductor



- § Wafer production
- § Front-end
- § Back-end
- § Electronic production

Solar



- § Wafer sawing
- § Laser edging
- § Stringing
- § Lay-up
- § Lamination
- § Transfer

- § Reduced time-to-market due to well-established know-how and extensive multi-technology competence
- § Reduced overall costs by means of high-end automation systems
- § Highest productivity due to perfect interaction of all technologies
- § Maximized, reproducible product quality due to highly precise open- and closed-loop control procedures
- § Global network with industry experts at the development and production locations of the industry

Solutions for all process steps

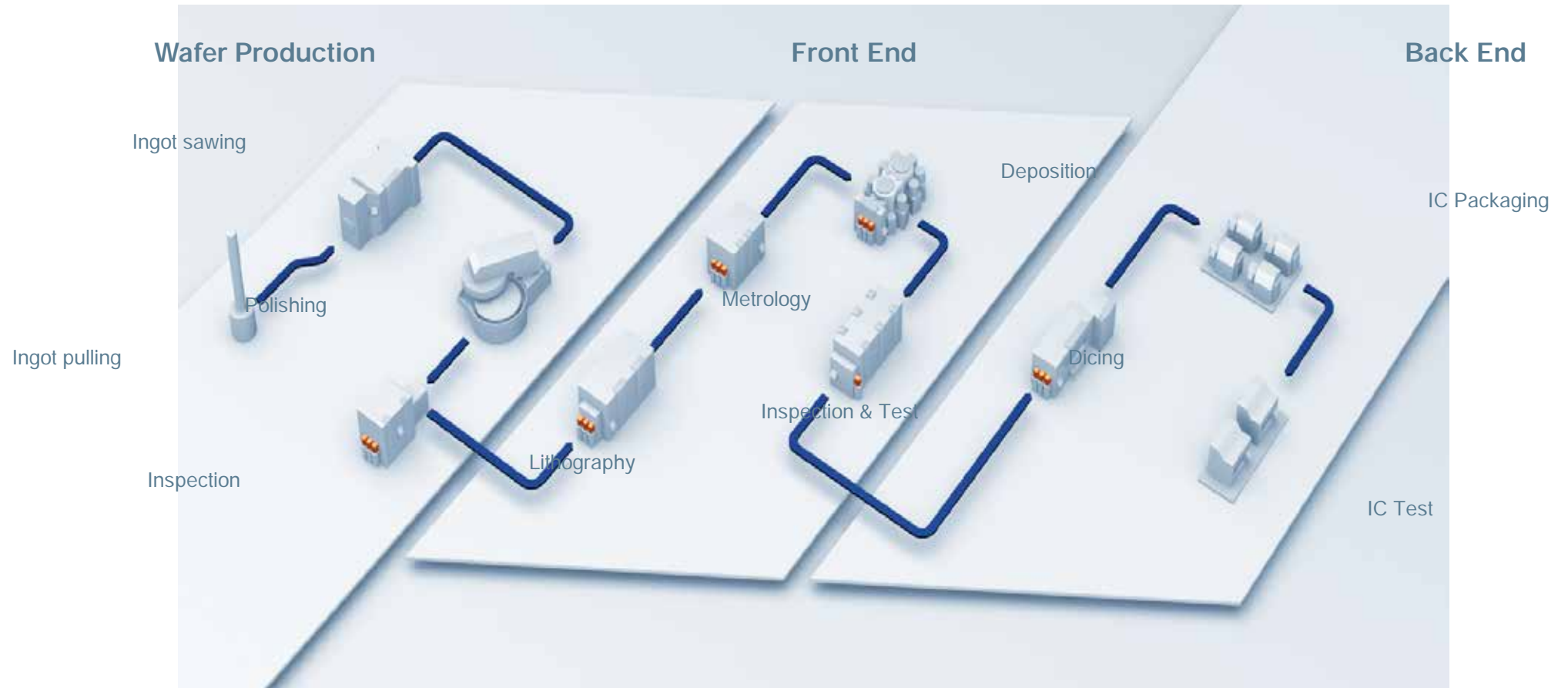

Back End



Animation

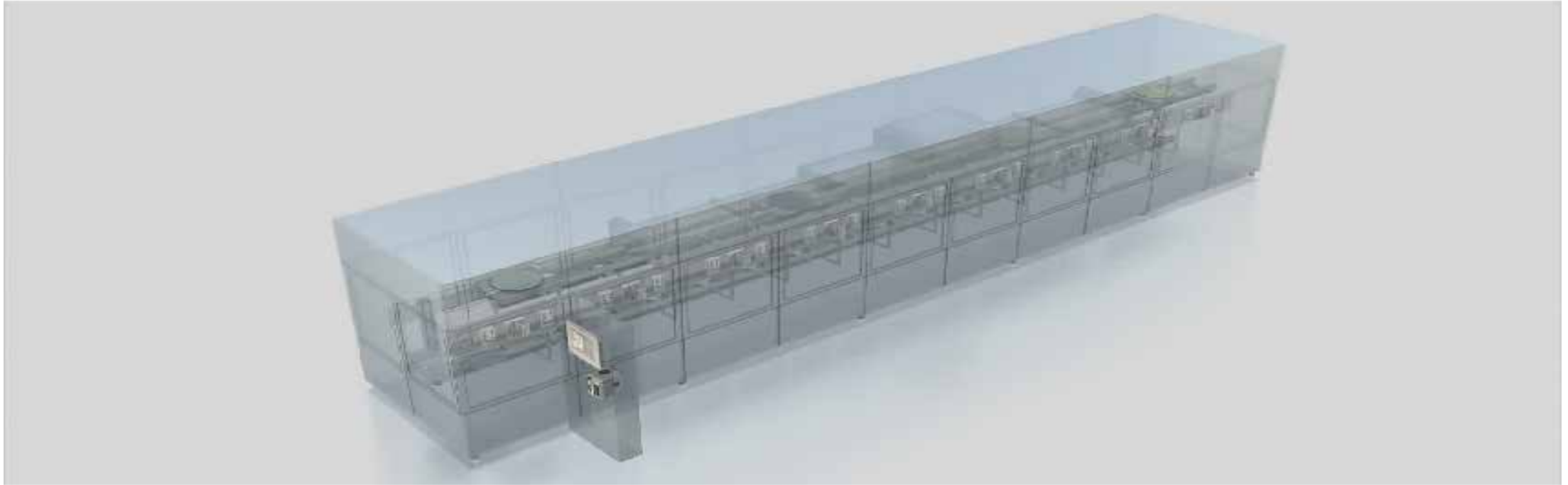

NYCe4000

Ethernet



Standard PC

- § 1 Node supports 1 to 10 axes
- § Each node has 1 CPU
- § Nodes usually connected to PC initiating the movements
- § Standard and customized nodes

Flexible control nodes

